

PAPER TITLE, FONT TYPE-CAMBRIA, BOLD, FONT SIZE 14

First Author *1, Second Author*2, Third Author*3 (Font-Cambria, Bold, Font Size -12)

*1Affiliation, Department, Institute, City, State, Country (Font-Cambria, Font Size -11)

*2Affiliation, Department, Institute, City, State, Country

*3Affiliation, Department, Institute, City, State, Country

(Ex- Professor, Department of ABC Engineering, Institute Name, City, state, Country)

ABSTRACT (Font-Cambria, Bold, Font Size -12)

An abstract is a summary of entire paper should be written in Times new roman with font size- 10. The abstract should not be more than 200 words and written in single paragraph. This electronic document is a “live” template. The abstract includes the overall purpose of the study you investigated, the basic design of the study, results of your analysis and brief summary of your interpretations and conclusion

Keywords: Analysis, investigation, research (5-6 Keywords, Font-Cambria, Font Size - 10).

I. INTRODUCTION (Font-Cambria, Bold, Font Size -12)

The introduction should be typed in Times New with font size 10. In this section highlight the importance of topic, making general statements about the topic and Presenting an overview on current research on the subject. The simplest way is to replace(copy-paste) the content with your own material. Your introduction should clearly identify the subject area of interest.

II. METHODOLOGY

Method and analysis which is performed in your research work should be written in this section. A simple strategy to follow is to use keywords from your title in first few sentences.

Subheading

Subheading should be Font Size- 10pt, Font Type- Cambria, justified.

Subheading

Subheading should be 10pt Times new Roman,

III. MODELING AND ANALYSIS

Model and Material which are used is presented in this section. Table and model should be in prescribed format.

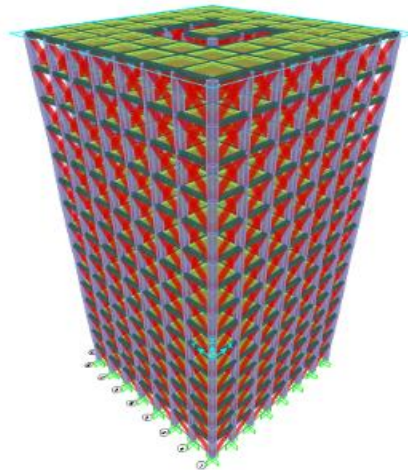

Figure 1: 3D view of building.

IV. RESULTS AND DISCUSSION

The results and discussion may be combined into a common section or obtainable separately. They may also be broken into subsets with short, revealing captions. An easy way to comply with the conference paper formatting requirements is to use this document as a template and simply type your text into it. This section should be typed in character size 10pt Times New Roman.

Table 1. Comparison of displacement of all 4 cases

SN.	Model Type	Seismic Zone	Displacement
1	Model-A	4	10.044 mm
2	Model-B	4	11.335 mm
3	Model-C	4	10.248 mm
4	Model-D	4	11.364 mm
5	Model-E	4	12.16 mm
6	Model-F	4	10.99 mm
7	Model-G	4	11.29mm

8	Model-H	4	13.20mm
9	Model-I	4	9.2mm

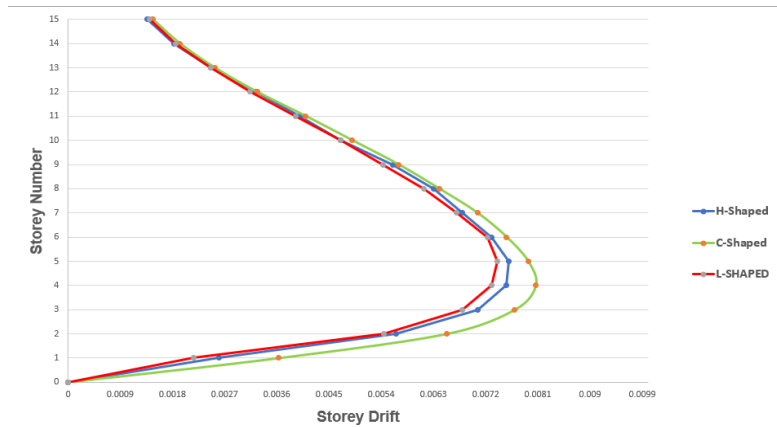

Figure 2: Name of Graph (Font size-10)

V. CONCLUSION

All the main points of the research work are written in this section. Ensure that abstract and conclusion should not same. Graph and tables should not use in conclusion.

ACKNOWLEDGEMENTS (optional)

The authors can acknowledge professor, friend or family member who help in research work in this section.

VI. REFERENCES

- [1] T. Mohana Priya, Dr. M. Punithavalli & Dr. R. Rajesh Kanna, Machine Learning Algorithm for Development of Enhanced Support Vector Machine Technique to Predict Stress, Global Journal of Computer Science and Technology: C Software & Data Engineering, Volume 20, Issue 2, No. 2020, pp 12-20
- [2] Ganesh Kumar and P.Vasanth Sena, "Novel Artificial Neural Networks and Logistic Approach for Detecting Credit Card Deceit," International Journal of Computer Science and Network Security, Vol. 15, issue 9, Sep. 2015, pp. 222-234
- [3] Gyusoo Kim and Seulgi Lee, "2014 Payment Research", Bank of Korea, Vol. 2015, No. 1, Jan. 2015.
- [4] Chengwei Liu, Yixiang Chan, Syed Hasnain Alam Kazmi, Hao Fu, "Financial Fraud Detection Model: Based on Random Forest," International Journal of Economics and Finance, Vol. 7, Issue. 7, pp. 178-188, 2015.
- [5] Hitesh D. Bambhava, Prof. Jayeshkumar Pitroda, Prof. Jaydev J. Bhavsar (2013), "A Comparative Study on Bamboo Scaffolding And Metal Scaffolding in Construction Industry Using Statistical Methods", International Journal of Engineering Trends and Technology (IJETT) - Volume 4, Issue 6, June 2013, Pg.2330-2337.
- [6] P. Ganesh Prabhu, D. Ambika, "Study on Behaviour of Workers in Construction Industry to Improve Production Efficiency", International Journal of Civil, Structural, Environmental and Infrastructure Engineering Research and Development (IJCSEIERD), Vol. 3, Issue 1, Mar 2013, 59-66